

# Hockey Feasibility Study: Test Fit

Three Conceptual Design Options, Providing a Test Fit for the Orientation & Location of the Ice Rink

July 5, 2022

Seawolf Sports Center Hockey Expansion	Option A Rotated Rink	Option B Shifted Rink	Option C Rink Stays in Place
Size	65,750 SF	49,660 SF	13,150 SF
Approximate Cost @\$1,000 SF	65.8 Million	49.7 Million	13Mill + 28,360 SF @ \$500/SF = 27.3 Million
Seating Capacity	3,021 Approximate Seats + Standing	2,978 Approximate Seats + Standing	2,210 Approximate Seats + Standing
Club Box Suites	10 Suites	6 Suites	0 Suites
Structure Impact	New Raised Roof Structure	New Raised Roof Structure	Reuse existing roof, new structure for expansion
Rink Impact	Rotate Rink 90 Degrees	Shift Rink North	Rink Stays In Place
Ice Plant Impact	None	None	None
Zamboni - Ice Met Pit Impact	Relocated	None	Relocated
Home Locker Rm Impact	None	None	None
Visiting Locker Room Plus Team Rooms	Yes	Yes	Yes
Spine Level Circulation around Rink	Yes	Yes	No
Circulation at Rink Level	Yes	Yes	No
Realignment of North Fire Lane	Yes	Yes	Yes
Potential Construction Phasing Oppourtunities	1) Structure, Shell, Ice Rink, West Lower Seating, and West Support Spaces (80% of Construction Cost.) 2) 20% for balance of East build-out	1) Structure, Shell, Ice Rink, South Lower Seating, and South Support Spaces (80% of Construction Cost.) 2) 20% for balance of North build-out	1) New Expanded South Bleachers (5% Construction) 2) Structure, Shell, Ice Rink, South Lower Seating, and South Support Spaces 80% of Construction Cost. 3) 15% for balance of North build-out

Options Data Comparison

July 5, 2022

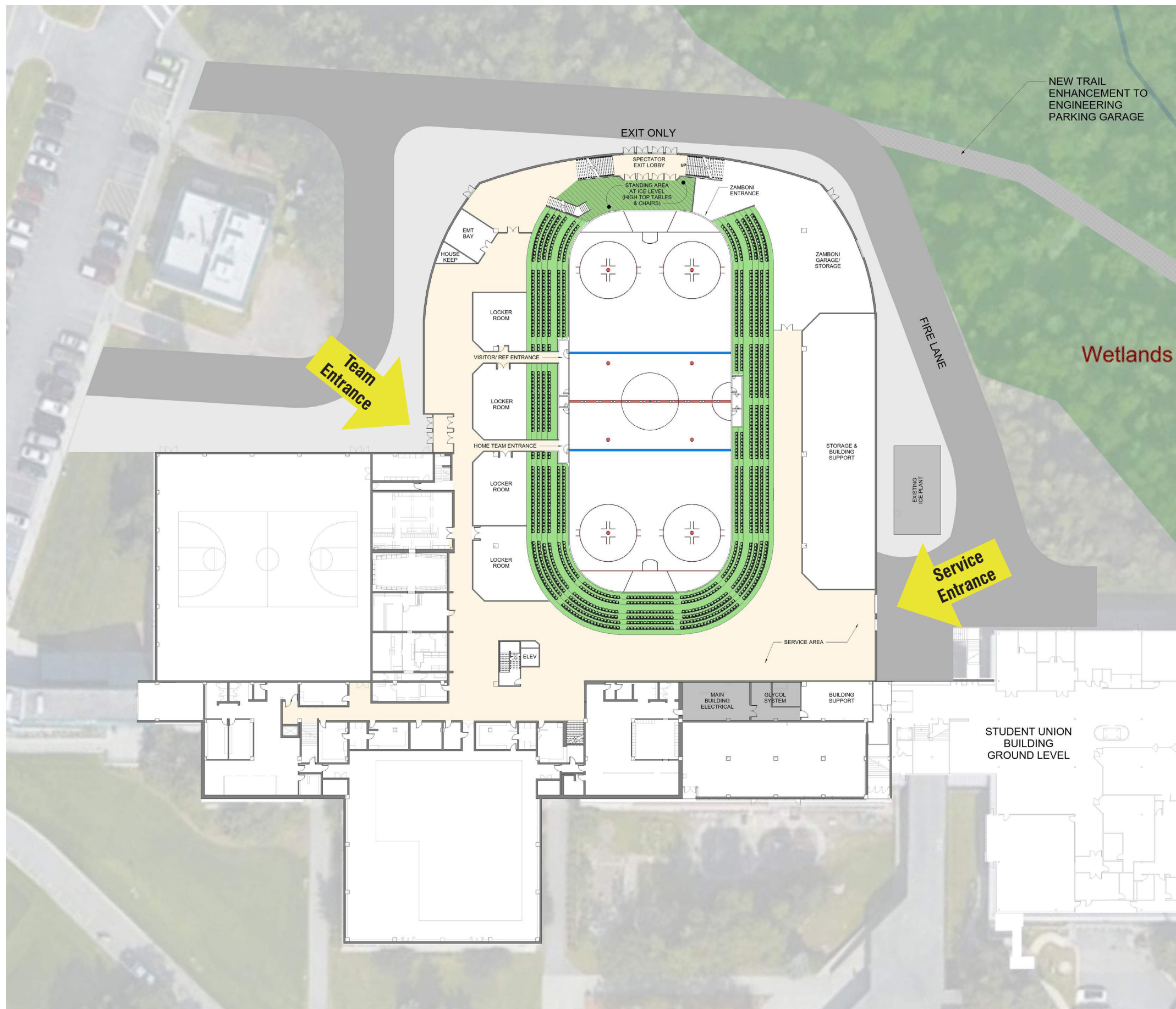

Option A : Rink Level Plan

July 5, 2022

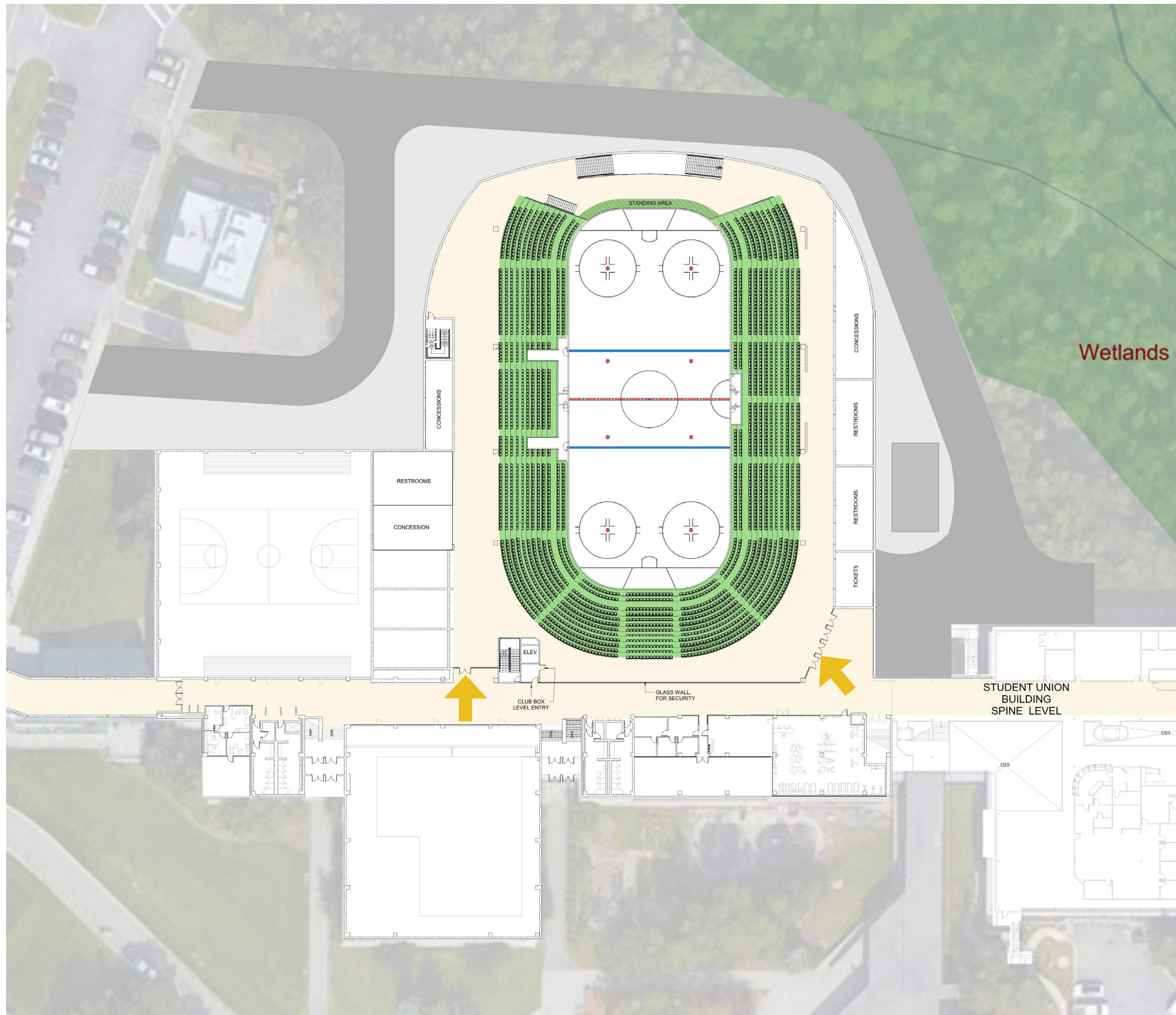

Seawolf Sports Center Hockey Expansion	Option A Rotated Rink
Size	65,750 SF
Approximate Cost @\$1,000 SF	65.8 Million
Seating Capacity	3,021 Approximate Seats + Standing
Club Box Suites	10 Suites
Structure Impact	New Raised Roof Structure
Rink Impact	Rotate Rink 90 Degrees
Ice Plant Impact	None
Zamboni - Ice Met Pit Impact	Relocated
Home Locker Rm Impact	None
Visiting Locker Room Plus Team Rooms	Yes
Spine Level Circulation around Rink	Yes
Circulation at Rink Level	Yes
Realignment of North Fire Lane	Yes
Potential Construction Phasing Oppourtunities	1) Structure, Shell, Ice Rink, West Lower Seating, and West Support Spaces (80% of Construction Cost.) 2) 20% for balance of East build-out

Option A : Spine Level Plan

July 5, 2022

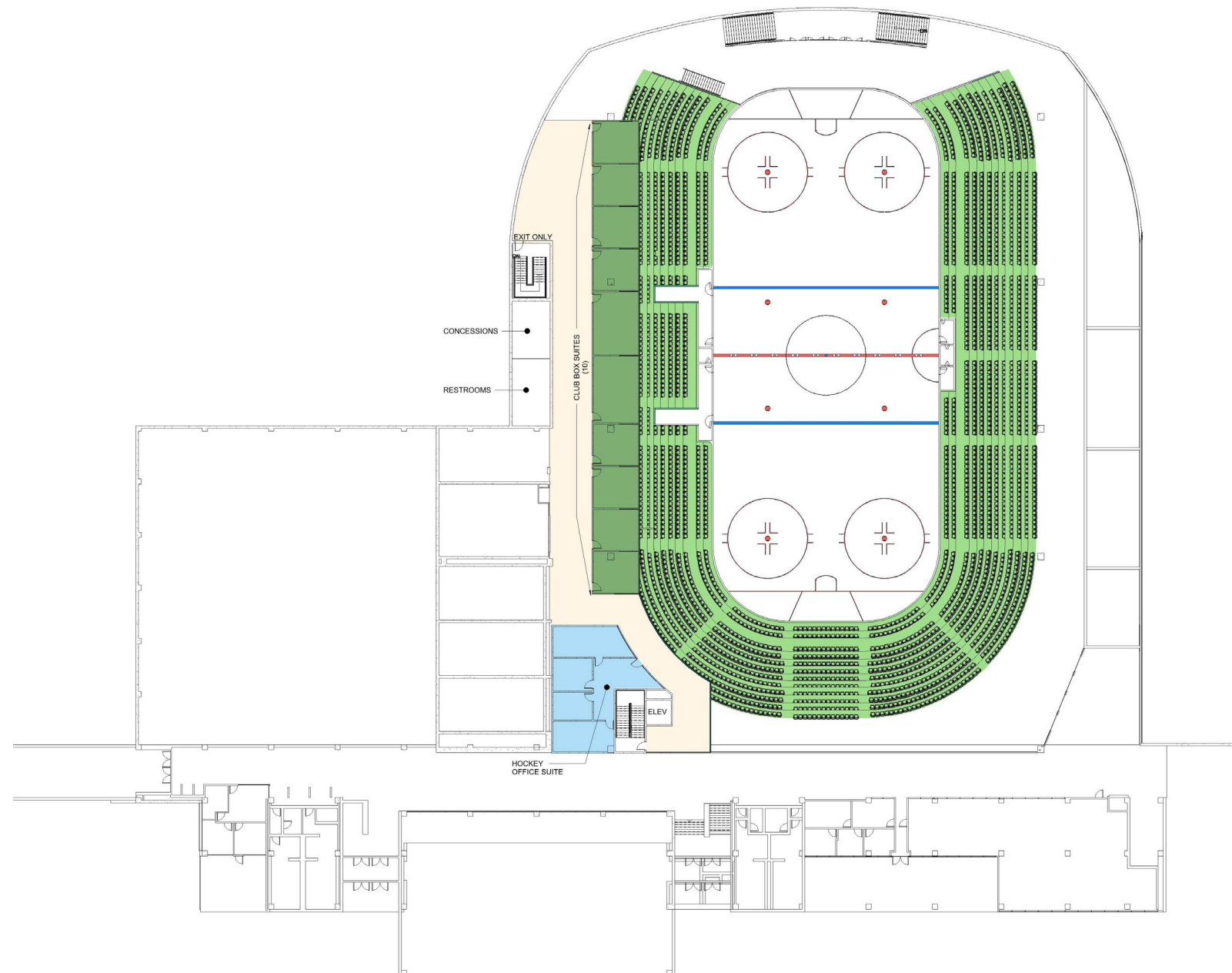

Option A : Club Box Level Plan

July 5, 2022

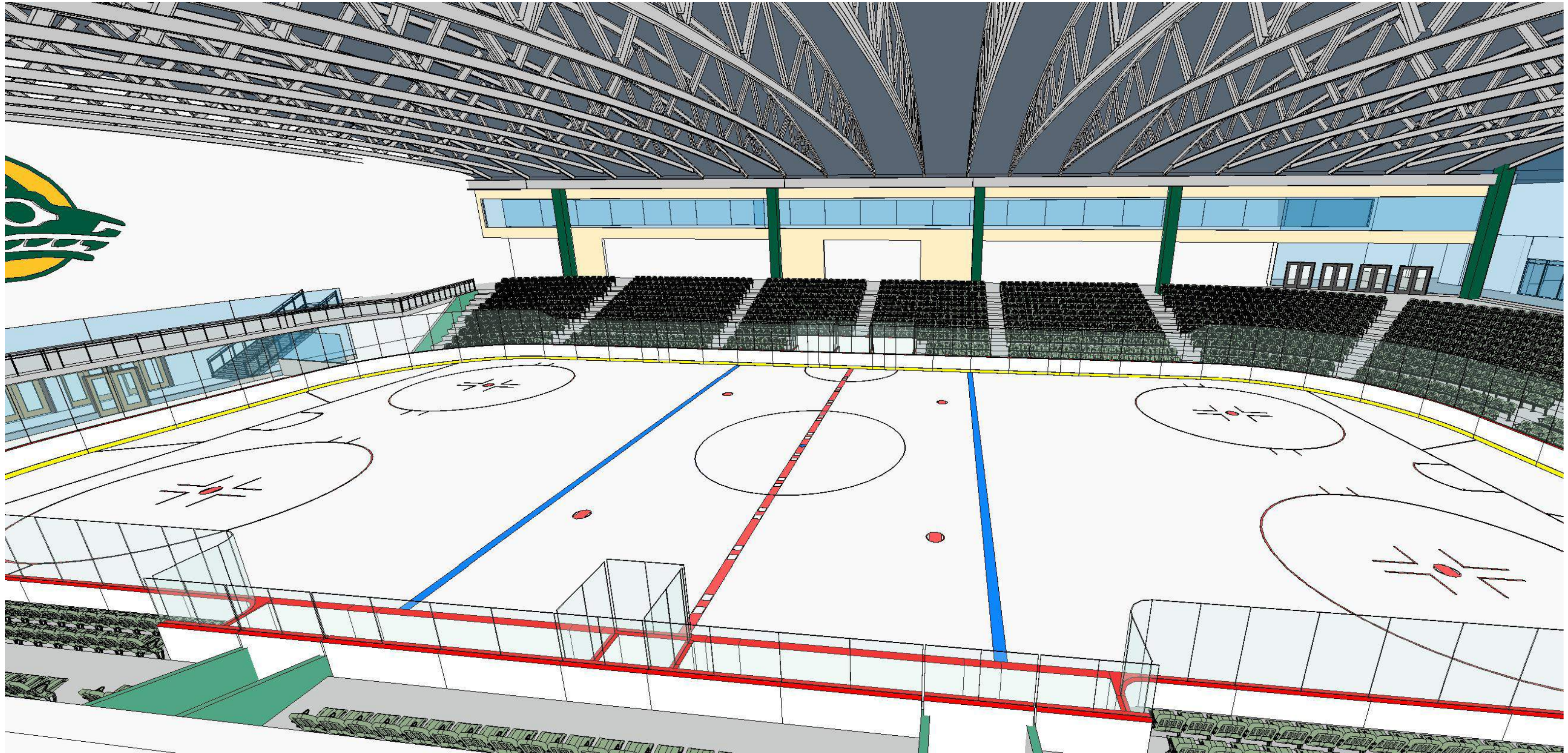

Option A : View from Club Box Suites

July 5, 2022

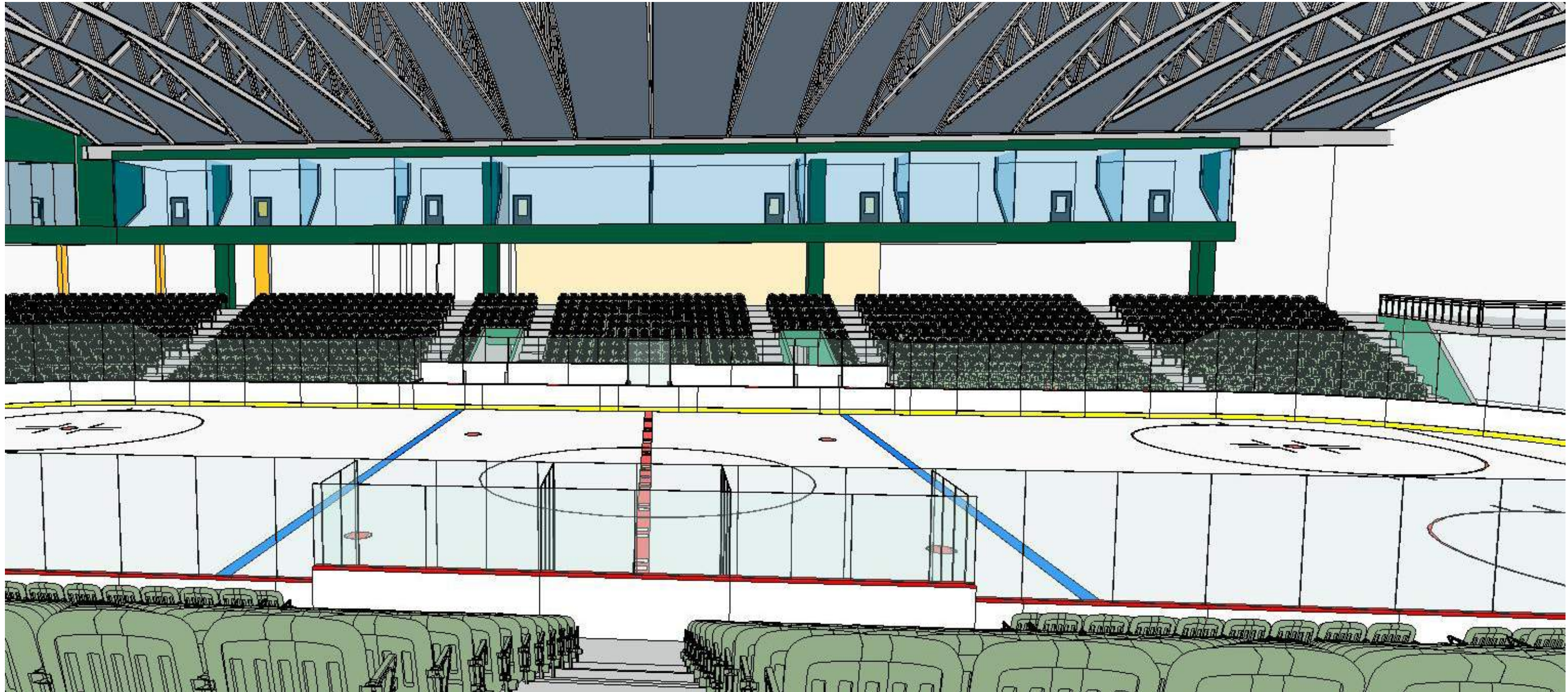

Option A : View From East Side

July 5, 2022

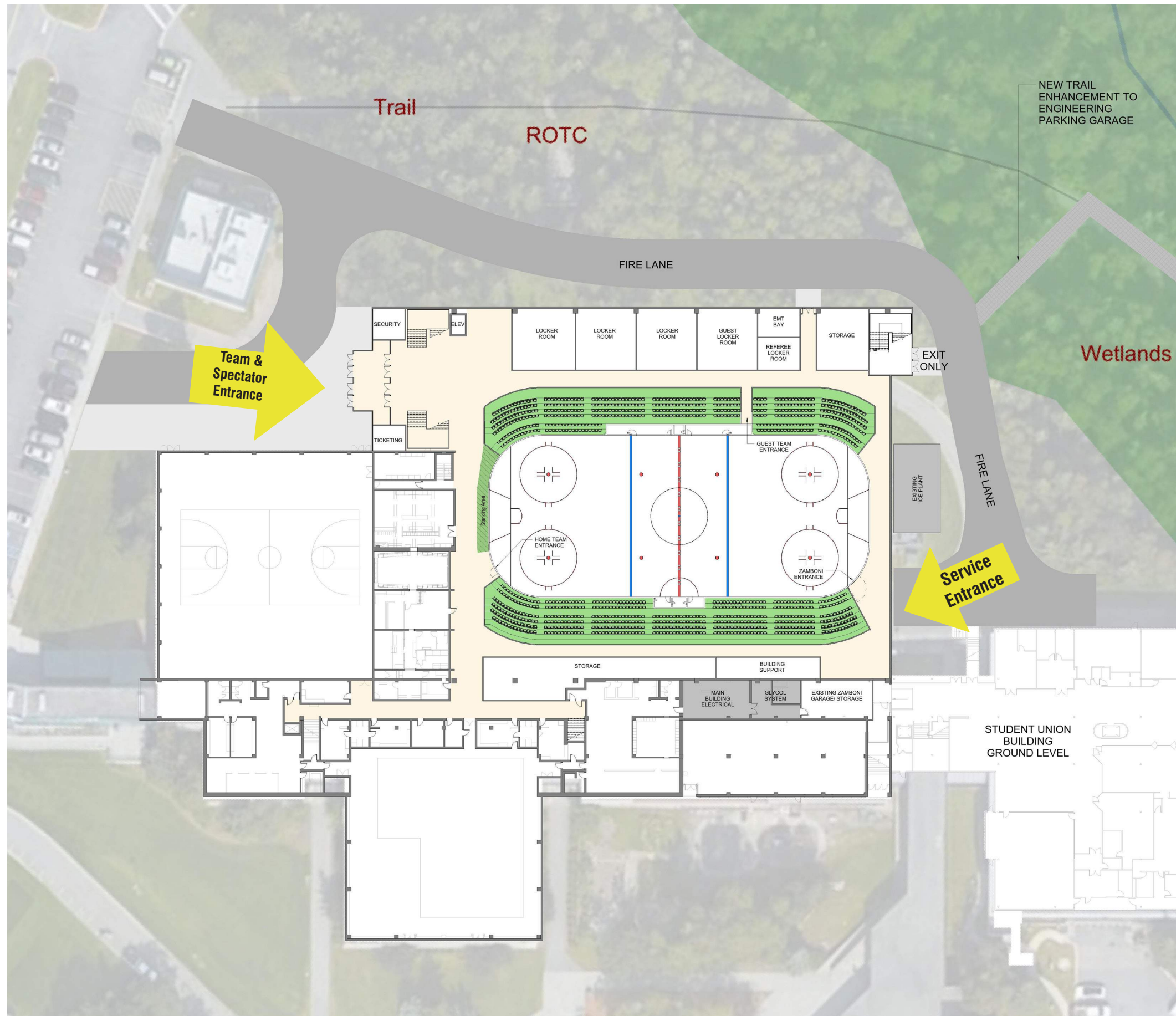

Option B : Rink Level Plan

July 5, 2022



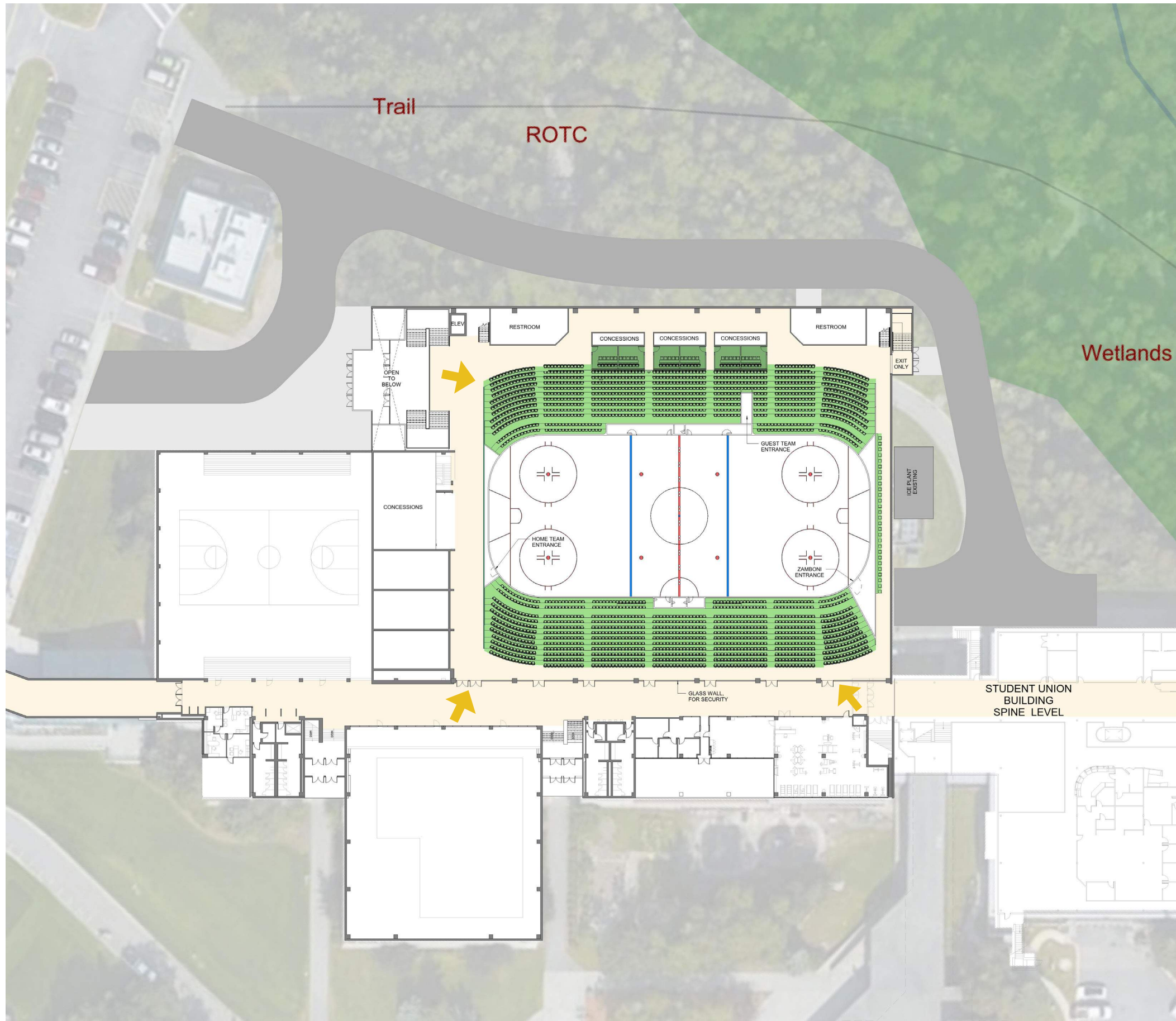

Seawolf Sports Center Hockey Expansion	Option B Shifted Rink
Size	49,660 SF
Approximate Cost @\$1,000 SF	49.7 Million
Seating Capacity	2,978 Approximate Seats + Standing
Club Box Suites	6 Suites
Structure Impact	New Raised Roof Structure
Rink Impact	Shift Rink North
Ice Plant Impact	None
Zamboni - Ice Met Pit Impact	None
Home Locker Rm Impact	None
Visiting Locker Room Plus Team Rooms	Yes
Spine Level Circulation around Rink	Yes
Circulation at Rink Level	Yes
Realignment of North Fire Lane	Yes
Potential Construction Phasing Opportunities	1) Structure, Shell, Ice Rink, South Lower Seating, and South Support Spaces (80% of Construction Cost.) 2) 20% for balance of North build-out

Option B : Spine Level Plan

July 5, 2022

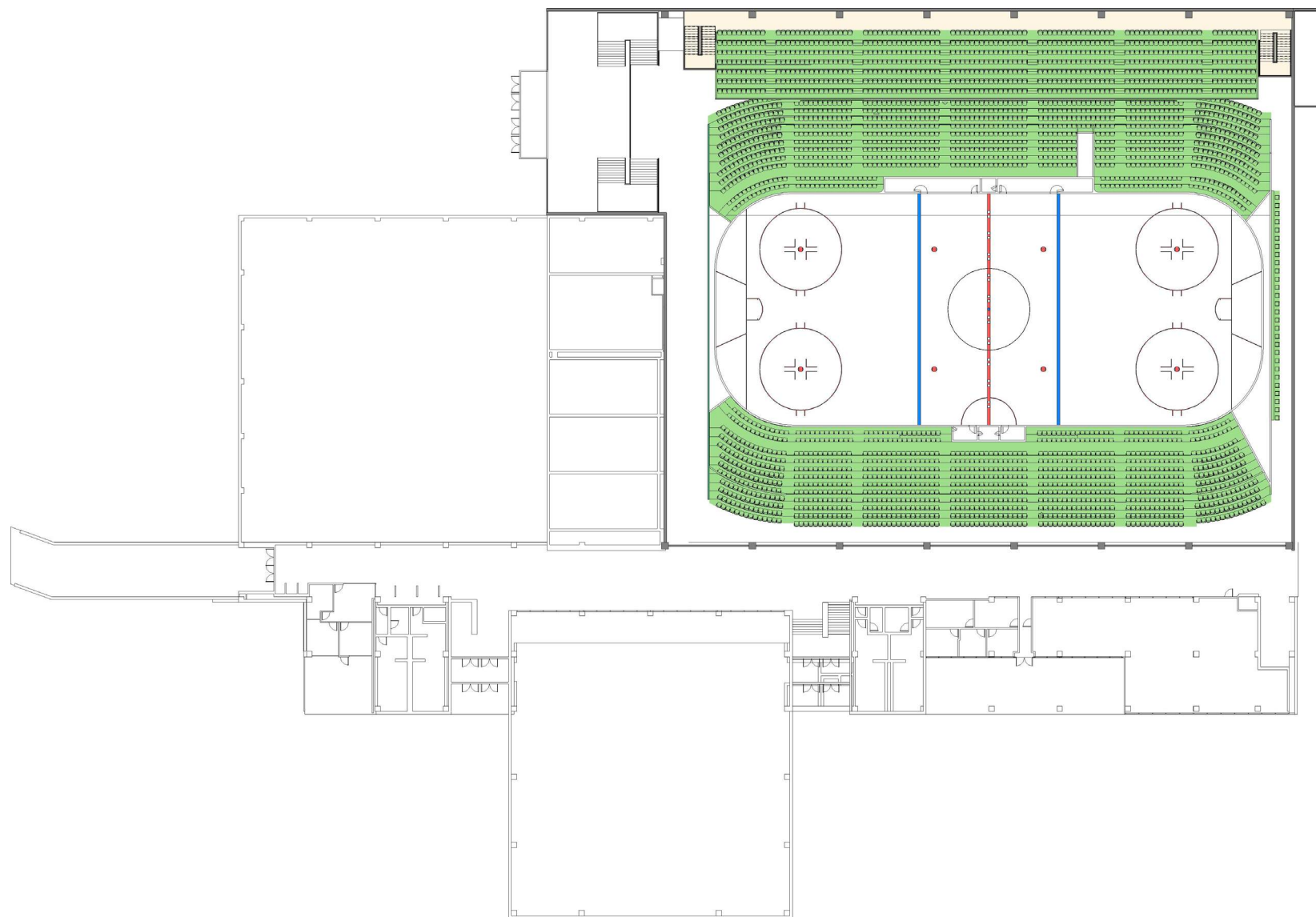

Option B : Upper Seating Level Plan

July 5, 2022

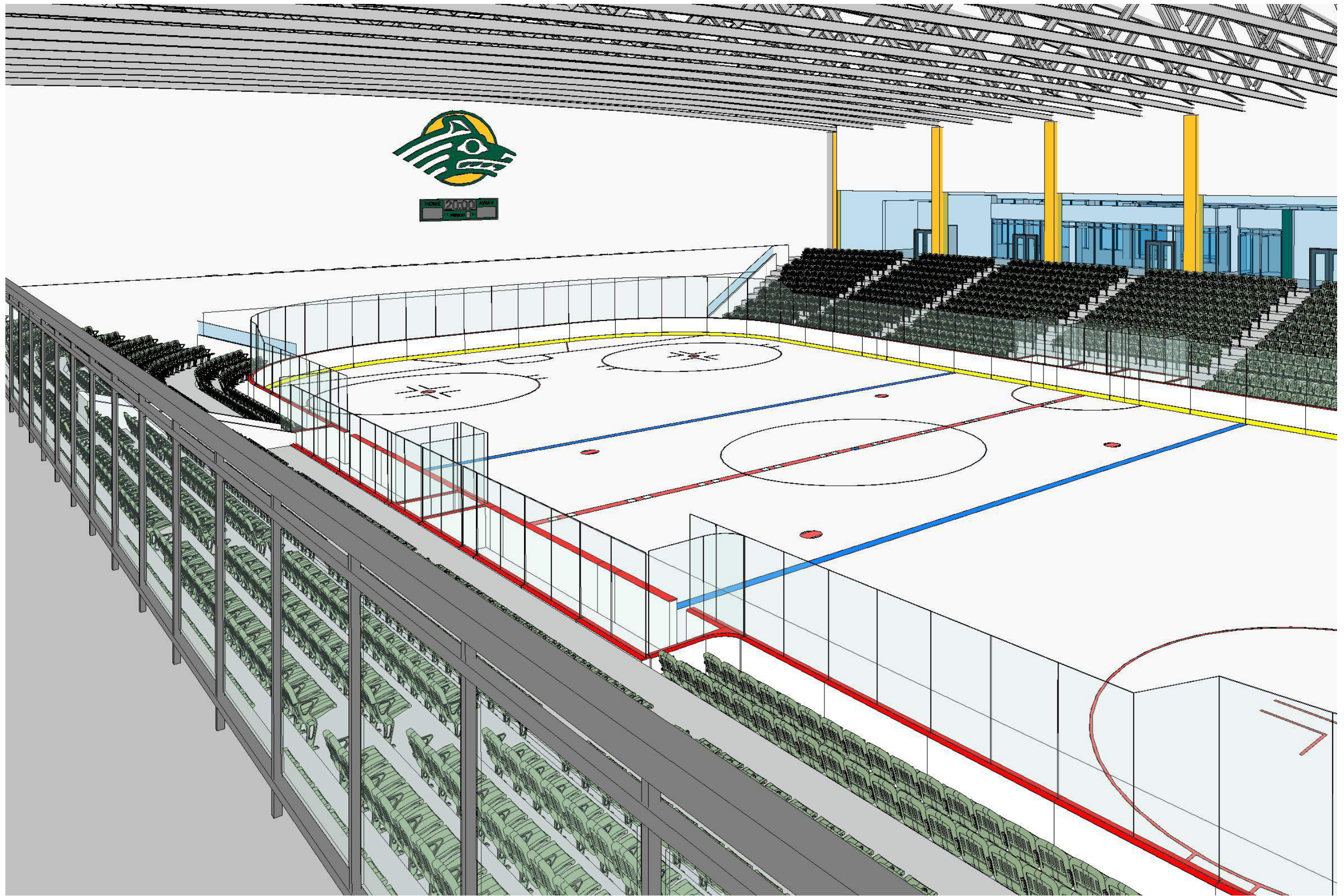

Option B : View from Upper Seating Area

July 5, 2022

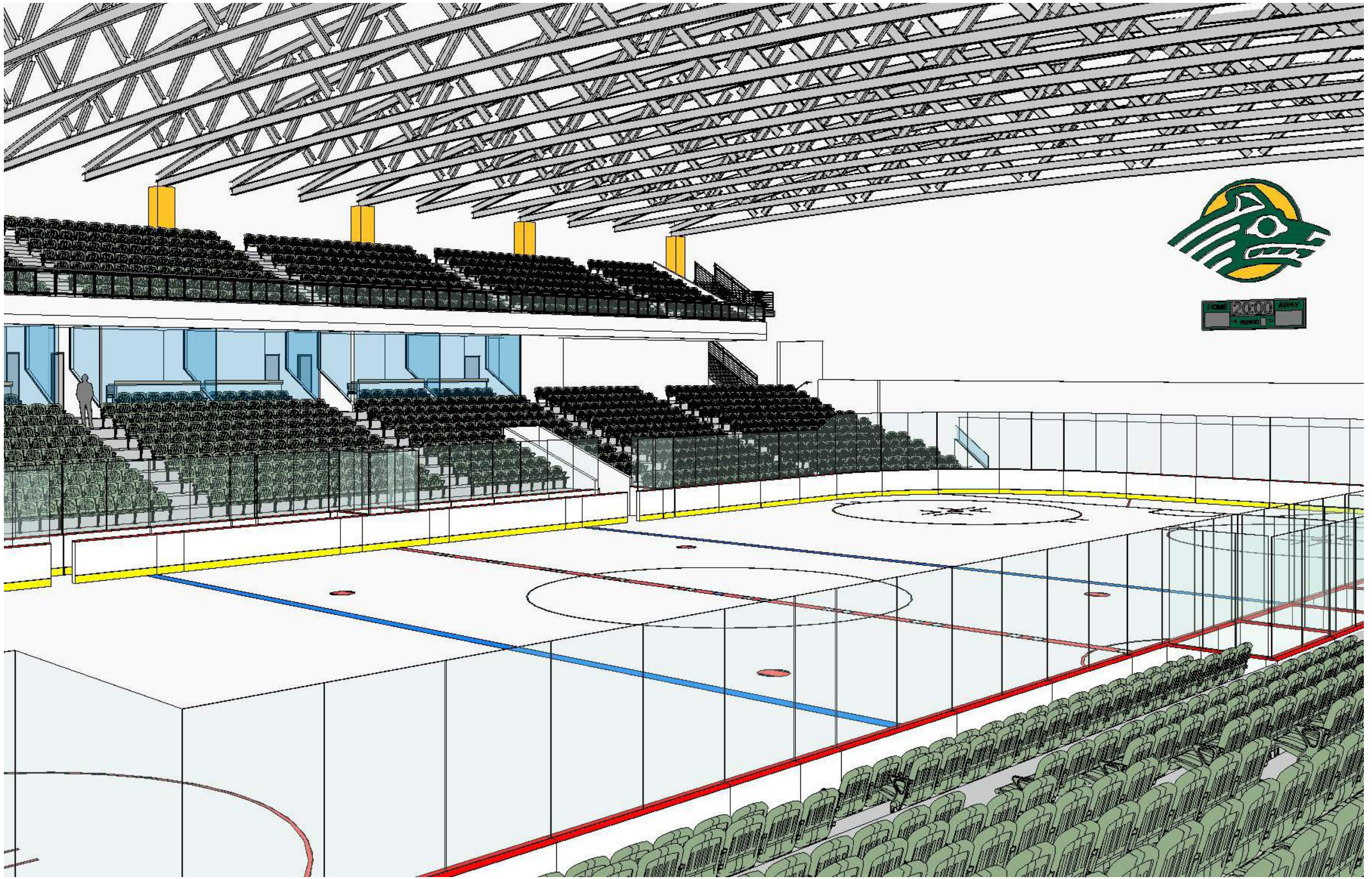

Option B : View from Spine Seating Area

July 5, 2022

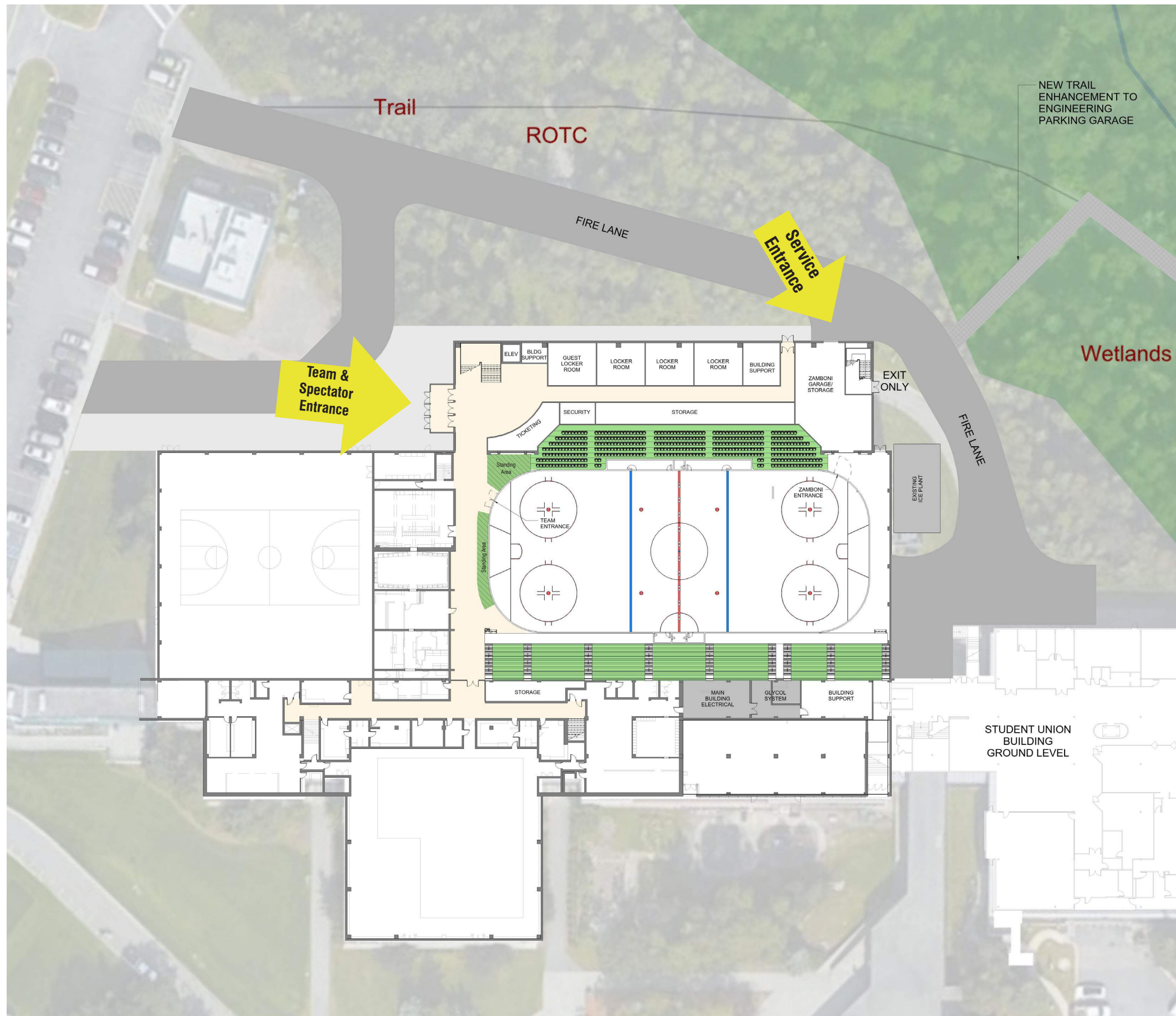

Option C : Rink Level Plan

July 5, 2022

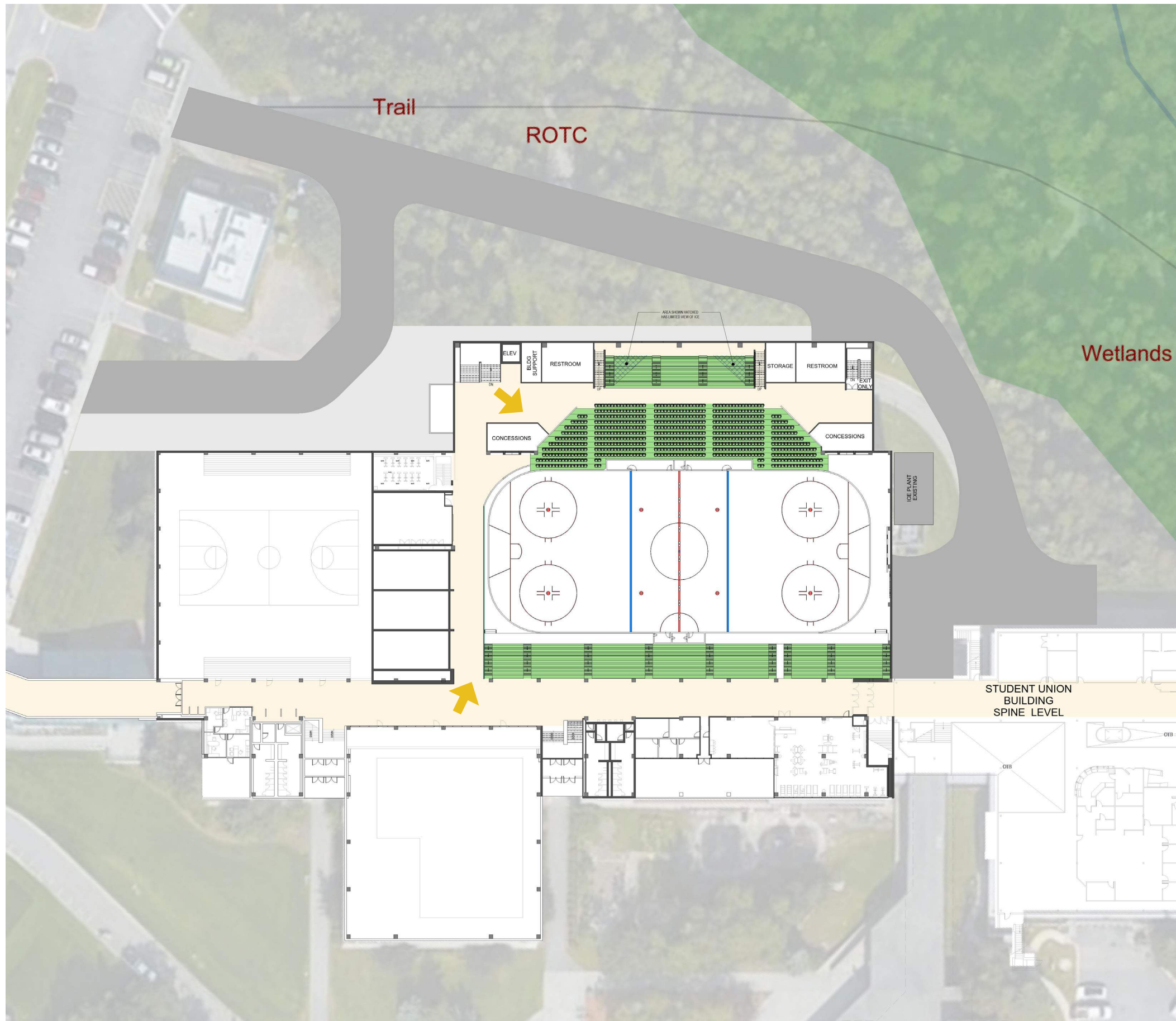

Seawolf Sports Center Hockey Expansion	Option C Rink Stays in Place
Size	13,150 SF
Approximate Cost @\$1,000 SF	13Mill + 28,360 SF @ \$500/SF = 27.3 Million
Seating Capacity	2,210 Approximate Seats + Standing
Club Box Suites	0 Suites
Structure Impact	Reuse existing roof, new structure for expansion
Rink Impact	Rink Stays In Place
Ice Plant Impact	None
Zamboni - Ice Met Pit Impact	Relocated
Home Locker Rm Impact	None
Visiting Locker Room Plus Team Rooms	Yes
Spine Level Circulation around Rink	No
Circulation at Rink Level	No
Realignment of North Fire Lane	Yes
Potential Construction Phasing Oppourtunities	1) New Expanded South Bleachers (5% Construction) 2) Structure, Shell, Ice Rink, South Lower Seating, and South Support Spaces 80% of Construction Cost. 3) 15% for balance of North build-out

Option C : Spine Level Plan

July 5, 2022

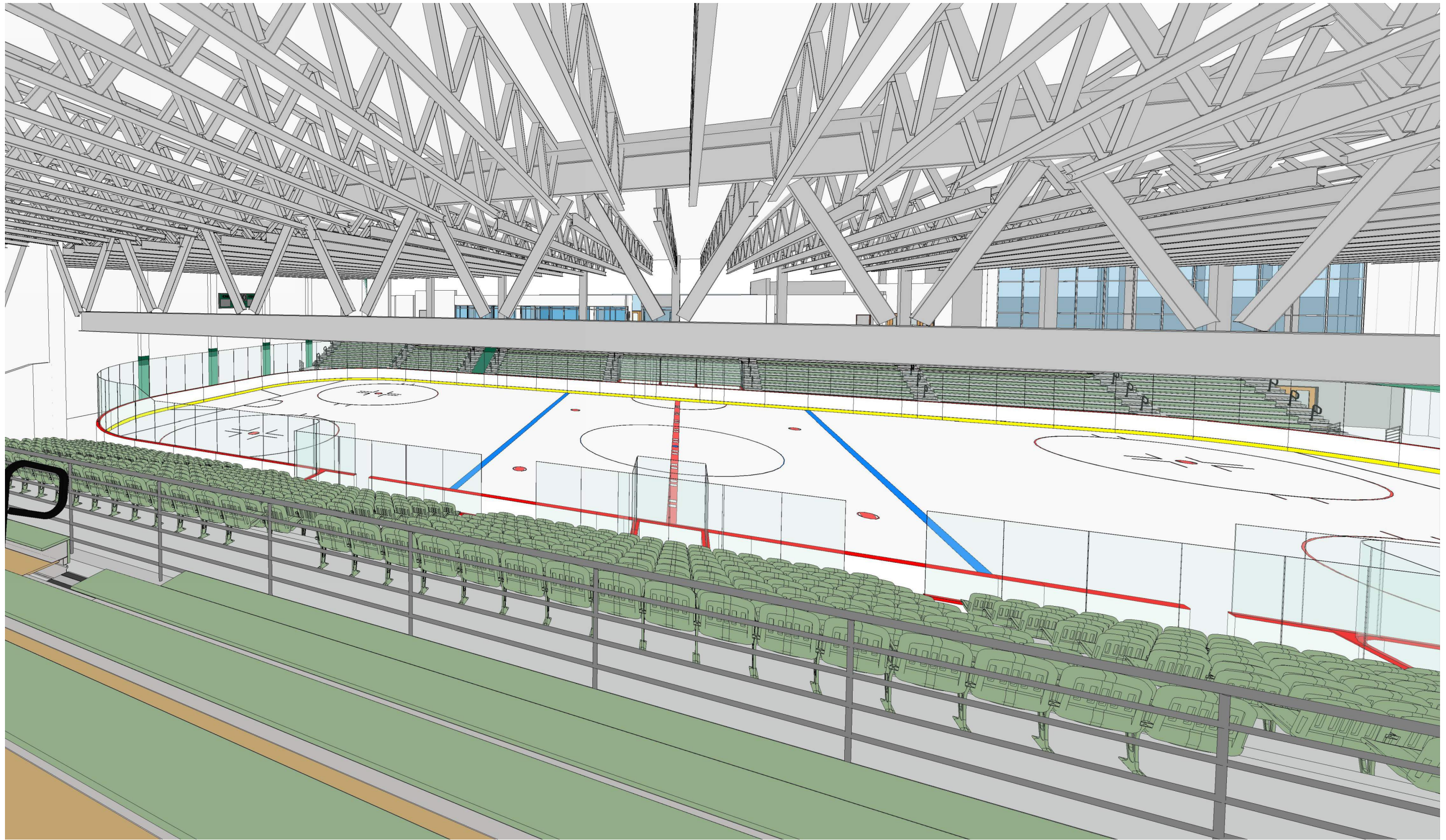

Option C : View from Upper Bench Seating

July 5, 2022

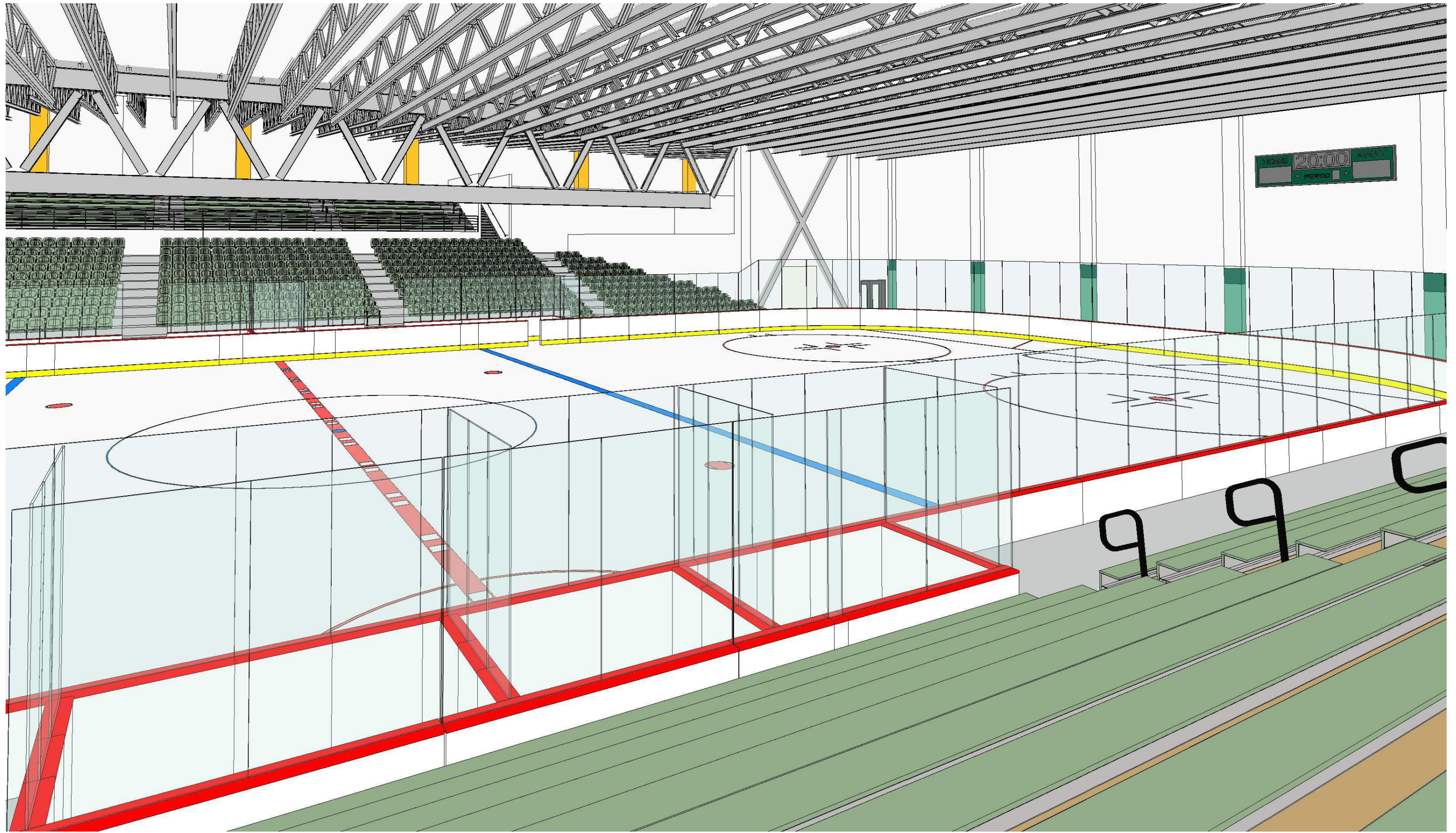

Option C : View from Spine Side Seating

July 5, 2022